

SUBMITTAL INFORMATION

Tee Head Adapter - (TAB - x style)

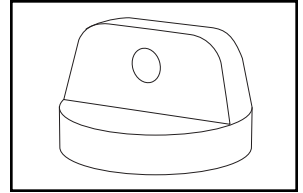

FOR 1-1/4", 1-1/2" AND 2" BALLCORPS

Hole for handle attachment

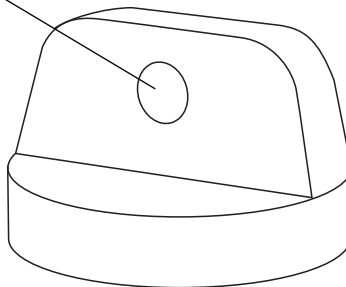

FOR BALLCORP SIZE	APPROX. WT. LBS.	PART NUMBER	✓ SUBMITTED ITEM(S)
1-1/4" and 1-1/2"	0.3	TAB - 6	
2"	0.3	TAB - 7	

FEATURES

- All brass conforms to AWWA Standard C800 (ASTM B-62 and ASTM B-584, UNS NO C83600 - 85-5-5-5)
- Hole is provided for handle attachment.
- Furnished with a 3/8" socket head cap screw for shop or field assembly.
- Can be factory assembled when purchased with any 1-1/4", 1-1/2" or 2" ball corporation stop.

The Ford Meter Box Company considers the information in this submittal form to be correct at the time of publication. Item and option availability, including specifications, are subject to change without notice. Please verify that your product information is current.



The Ford Meter Box Company, Inc.

P.O. Box 443, Wabash, Indiana U.S.A. 46992-0443

Phone: 260-563-3171 / Fax: 800-826-3487

Overseas Fax: 260-563-0167

<http://www.fordmeterbox.com>

12/13/07

Submitted By: