



Section **AB**

10/2008

Ford Drilling Machine

Parts and
Instruction
Manual



The Ford Meter Box Company, Inc.

775 Manchester Avenue, P.O. Box 443, Wabash, Indiana, USA 46992-0443
Telephone: 260-563-3171 FAX: 1-800-826-3487 Overseas FAX: 260-563-0167

<http://www.fordmeterbox.com>



Contents

	Page
Complete Drilling Machine Kit Information	
Optional Items	4
Drilling Machine Kits	
DMO	5
DMO-1-9A	5
DMK-1-12A	5
Optional items for 1/2" through 1-1/4" drilling requirements	5
Optional Items for 1-1/4" through 2" drilling requirements	6
Drilling Machine Component Information Charts	
Cutting Tools	7
Adapters	7
Boring Bars	7
Operating Instructions	8
Assembly Instructions for Shell Cutters	9
Drilling Machine Adapters	
Recommended Drill Sizes	10
Recommended Drill Machine Adapters	10
Recommended Tapping Machine Adapters	10
Warranty	12

Information

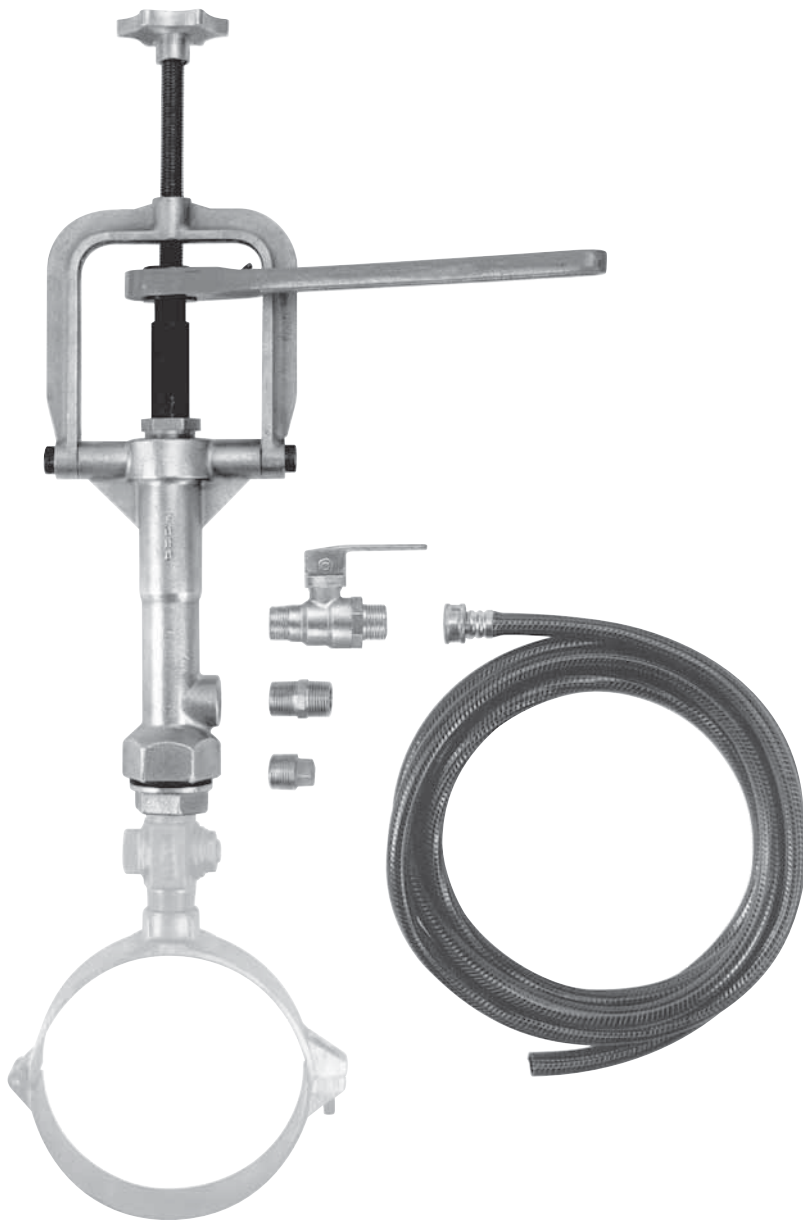

DMRW Ratchet Wrench - Periodic maintenance is required, the frequency is determined by the degree of exposure to harmful elements, such as sand, dirt, etc. It is recommended to submerge the head of the ratchet in diesel fuel to loosen internal dirt. Liquid applied thread lock should be refreshed occasionally to ensure cover plate screws remain secure.

The Ford Complete Drilling Machine Kit includes:

- The Drilling Machine (items 1 through 9A on page 5)
- Flare Copper Thread Adapters for 3/4" and 1" Corporation Stops (item 10)
- Two small adjustable open end wrenches (item 11)
- Tool box (item 12)

Optional Items

- 1/2" thru 1" Drills for Cast Iron and A/C
 - 1/2", 3/4" & 1" Shell Cutters for PVC
 - 1-1/4" Drill for Ductile Iron or A/C
 - 1-1/4", 1-1/2" and 2" Shell Cutters for PVC and A/C
 - 1-1/2" and 2" Shell Cutters for Ductile Iron
 - 2" Hole Saw for Ductile Iron, PVC and A/C
 - Boring Bars for other sizes of Corporation Stops
 - Adapters for different sizes and styles of Corporation Stops
 - Chip flushing equipment (page 5) (See Ordering Information below)
1. Substitute valve or hose adapter for plug. Attach hose.
 2. When Drill or PVC Cutter cuts through main, water pressure tends to wash chips through machine and hose.

Ordering Information

Drilling Machine only includes items 1 through 9A on page 5.

Complete Drilling Machine Kit includes items 1 through 12 on page 5. Drills, Shell Cutters and Hole Saw should be ordered separately.

Optional items and spare parts should be ordered separately by name and catalog number on pages 5 & 6.

The Ford Drilling Machine

DRILLING MACHINE KITS

CATALOG NUMBER	DESCRIPTION
DMO	Model 77 Drilling Machine body only (items 1 thru 8) (10 lb.)
DMO-1-9A	Model 77 Drilling Machine only (items 1 thru 9A)
DMK-1-12A	Model 77 Drilling Machine Kit Complete (items 1 thru 12) (36 lb.)

Drills, Cutters and Hole Saws are not included with kits. See page 7 for a complete list of these items.

DRILLING MACHINE COMPONENTS

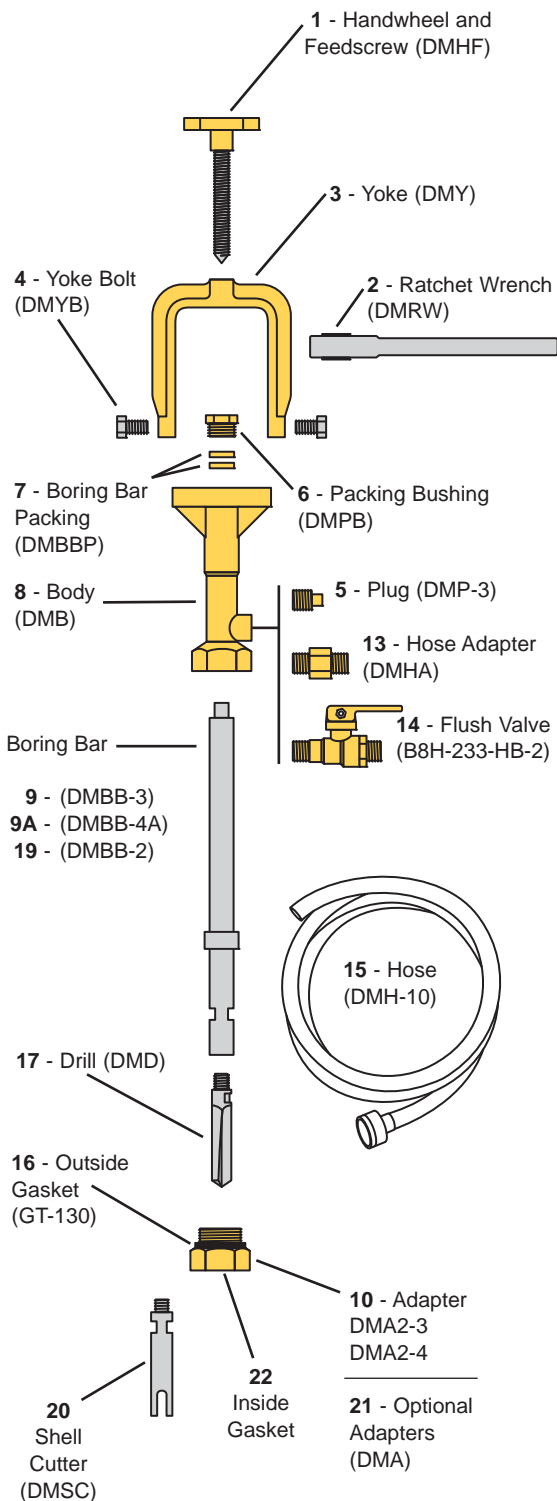

REF. No.	DESCRIPTION	CATALOG NUMBER
1	Handwheel and Feedscrew	DMHF
2	Ratchet Wrench	DMRW
3	Yoke	DMY
4	Yoke Bolts (2)	DMYB
5	Plug - 3/4" iron pipe thread	DMP-3
6	Packing Bushing	DMPB
7	Boring Bar Packing (2)	DMBBP
8	Body	DMB
9	Boring Bar only (fits 11/16" Drill & Shell Cutter for 3/4" Corp Stop)	DMBB-3
9A	Boring Bar only (fits 7/8" Drill & Shell Cutter for 1" Corp Stop)	DMBB-4A
10	3/4" Flare Copper adapter w/gaskets	DMA2-3
	1" Flare Copper adapter w/gaskets	DMA2-4
11	Open end adjustable wrenches (2)	DMAW-PR
12	Tool Box	DMTB

Optional items

-	Drilling Machine Ratchet Wrench Repair Kit	DMRWRK
13	Hose adapter for chip flushing	DMHA
14	Ball Valve with hose threads for chip flushing	B8H-233-HB-2
15	12-1/2 ft. hose for chip flushing	DMH-10
16	Outside gasket for all Corp Stop Adapters	GT-130

OPTIONS FOR 1/2" - 1-1/4" DRILLING REQUIREMENTS

17	7/16" Drill for 1/2" Corp Stop (fits Boring Bar DMBB-1)	DMD-1
	9/16" Drill for 5/8" Corp Stop (fits Boring Bar DMBB-2)	DMD-2
	11/16" Drill for 3/4" Corp Stop (fits Boring Bar DMBB-3)	DMD-3
	7/8" Drill for 1" Corp Stop (fits Boring Bar DMBB-4A)	DMD-4A
19	Boring Bar for 7/16" Drill for 1/2" Corp Stop	DMBB-1
	Boring Bar for 9/16" Drill for 5/8" Corp Stop	DMBB-2
20	7/16" Shell Cutter for PVC (fits Boring Bar DMBB-1)	DMSC-1
	11/16" Shell Cutter for PVC (fits Boring Bar DMBB-3)	DMSC-3
	7/8" Shell Cutter for PVC (fits Boring Bar DMBB-4A)	DMSC-4A
	1/2" Flare Copper adapter with gaskets	DMA2-1
21	5/8" Flare Copper adapter with gaskets	DMA2-2
	1-1/4" Flare Copper adapter with gaskets	*DMA2-5
	1-1/4" Quick Joint adapter with gaskets (CTS)	DMA4-5-Q
	3/4" Female Iron Pipe adapter with gaskets	DMA1-3
	1" Female Iron Pipe adapter with gaskets	DMA1-4
	1-1/4" Female Iron Pipe adapter with gaskets	*DMA1-5
	1-1/4" Quick Joint Adapter with gaskets (CTS)	*DMA4-5-Q
	3/4" Quick Joint Adapter with gaskets (PEP)	DMA6-3-Q
	1" Quick Joint Adapter with gaskets (PEP)	DMA6-4-Q
	22	Inside gasket for 1/2" Flare Copper adapter
Inside gasket for 5/8" Flare Copper adapter		GT-107
Inside gasket for 3/4" Flare Copper adapter		GT-118
Inside gasket for 1" Flare Copper adapter		GT-119
Inside gasket for 1-1/4" Flare Copper adapter		GT-147
Inside gasket for 3/4" Iron Pipe adapter		GT-114
Inside gasket for 1" Iron Pipe adapter		GT-120
Inside gasket for 1-1/4" Iron Pipe adapter		GT-119

Note: 1-1/4", 1-1/2" and 2" equipment on following page.

* For use with 7/8" (1" nominal) drill or shell cutter. See following page for 1-1/8" cutters and adapters.

The Ford Drilling Machine

Optional Items for 1-1/4", 1-1/2" and 2" drilling requirements

The Ford Drilling Machine, with its light-weight design and size, is ideal for making taps up to 1". The Ford Drilling Machine can be adapted for 1-1/4", 1-1/2" and 2" taps. The following items will allow for OCCASIONAL taps for 1-1/4", 1-1/2" and 2". Please note that the Ford Drilling Machine is not recommended for making routine taps larger than 1".

CATALOG NUMBER	DESCRIPTION
ADAPTERS	
DMA1-6	1-1/2" FIP Adapter with gaskets
DMA2-6	1-1/2" Flare Copper Adapter with gaskets
DMA4-5F-Q	1-1/4" Quick Joint Adapter with gaskets (use with 1-1/8" Drill or Shell Cutter)
DMA4-6-Q	1-1/2" CTS Quick Joint Adapter with gaskets
DMA1-67	1-1/2" Adapter with 2" FIP threads for use with 1-1/2" FB800 and FB900 Corp Stops
DMA1-7	2" FIP Adapter with gaskets
DMA2-7	2" Flare Copper Adapter with gaskets
DMA4-7-Q	2" CTS Quick Joint Adapter with gaskets
DMA1-78	2" Adapter with 2-1/2" FIP threads for use with 2" FB800 and FB900 Corp Stops
DMA8-6	1-1/2" Adapter with 1-1/2" MIP threads for use with 1-1/2" FB1600 and FB1700 Corp Stops
DMA8-6-BSPT	1-1/2" Adapter with 1-1/2" MIP BSPT threads
DMA8-7	2" Adapter with 2" MIP threads for use with 2" FB1600 and FB1700 Corp Stops
DMA8-7-BSPT	2" Adapter with 2" MIP BSPT threads
DRILLS	
DMD-5-DI	1-1/8" Drill for 1-1/4" Corp Stop and DMA4-5F-Q (fits Boring Bar DMBB-67)
HOLE SAWS	
DMHS-7	1-7/8" Hole Saw for 2" Corp Stop (fits Arbor DMA-67)
DMHSS	Package of 6 Hole Saw Spacers
DMA-67	Arbor only for use with Boring Bar DMBB-67 (Includes DMPD Pilot Drill & DMHSS Spacer)
SHELL CUTTERS	
DMSC-5-PVC	1-1/8" Shell Cutter for 1-1/4" Corp Stop and DMA4-5F-Q (fits Boring Bar DMBB-67)
DMSC-6-DI	1-3/8" Shell Cutter for Ductile Iron Pipe, 1-1/2" Corp Stop (fits Boring Bar DMBB-67) (Includes DMPD Pilot Drill)
DMSC-6-PVC	1-3/8" Shell Cutter for PVC Pipe, 1-1/2" Corp Stop (fits Boring Bar DMBB-67)
DMSC-7-DI	1-7/8" Shell Cutter for Ductile Iron Pipe, 2" Corp Stop (fits Boring Bar DMBB-67) (Includes DMPD Pilot Drill)
DMSC-7-PVC	1-7/8" Shell Cutter for PVC Pipe, 2" Corp Stop (fits Boring Bar DMBB-67)
BORING BAR AND PILOT DRILL	
DMBB-67	Boring Bar for 1-1/4", 1-1/2" and 2" Corp Stops
DMPD	1/4" Pilot Drill for use with DMSC-6-DI, DMSC-7-DI or DMA-67 Arbor
ADAPTER GASKETS	
GT-119	Inside gasket for DMA6-3-Q Adapter
GT-128	Inside gasket for DMA6-4-Q Adapter
GT-126	Inside gasket for DMA4-6-Q Adapter
GT-127	Inside gasket for DMA4-7-Q Adapter
GT-143	Inside gasket for DMA2-6 and DMA1-67 Adapters
GT-142	Inside gasket for DMA1-6 Adapter
GT-144	Inside gasket for DMA1-7 Adapter
GT-132	Inside gasket for DMA2-7 and DMA1-78 Adapters

Note: 1-7/8" DMHS hole saws REQUIRE a DMA-67 Arbor

1-1/8", 1-3/8" and 1-7/8" DMSC shell cutters ATTACH to the DMBB-67 boring bar and will not fit a DMA-67 Arbor

Example of an DMA-67 2" Arbor Assembly (for Hole Saw only)

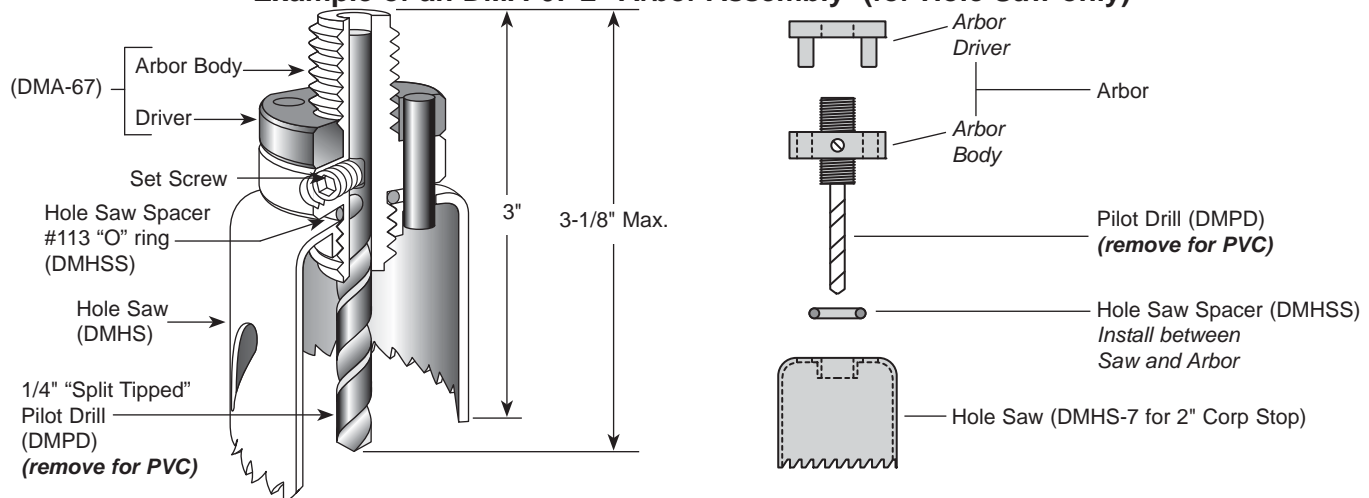

NOTE: All cutters and drills are perishable tools, which begin to wear upon initial use. Sharpness and operator handling are critical to the tool's performance.

The Ford Drilling Machine

Option Selection Charts: Cutting Tools, Adapters and Boring Bars

CUTTING TOOLS: To select a cutting tool, choose the proper column for type of water main. Select the Nominal Hole Size. The proper cutting tool catalog number is in the far left column.



3/4" & 1" Drill



3/4" & 1" Shell Cutter



1-1/2" & 2" Shell Cutter for PVC



1-1/2" & 2" Shell Cutter for Ductile Iron



2" Hole Saw

CATALOG NUMBER	DESCRIPTION	ACTUAL CUTTER DIAMETER	TYPE OF WATER MAIN (NOMINAL HOLE SIZE)		
			PVC	IRON	ASBESTOS CEMENT
DMD-1	Drill	7/16"		1/2"	1/2"
DMD-2	Drill	9/16"		5/8"	5/8"
DMD-3	Drill	11/16"		3/4"	3/4"
DMD-4A	Drill	7/8"		1"	1"
DMD-5-DI	Drill	1-1/8"		1-1/4"	1-1/4"
DMSC-1	Shell Cutter	7/16"	1/2"		
DMSC-3	Shell Cutter	11/16"	3/4"		
DMSC-4A	Shell Cutter	7/8"	1"		
DMSC-5-PVC	Shell Cutter	1-1/8"	1-1/4"		1-1/4"
DMSC-6-DI	Shell Cutter	1-3/8"		1-1/2"	
DMSC-6-PVC	Shell Cutter	1-3/8"	1-1/2"		1-1/2"
DMSC-7-DI	Shell Cutter	1-7/8"		2"	
DMSC-7-PVC	Shell Cutter	1-7/8"	2"		2"
DMHS-7	Hole Saw	1-7/8"	2"	2"	2"

ADAPTERS: To select an adapter, choose the proper column for corporation body outlet thread type (see Catalog Section A to determine a Corporation Body Outlet Thread type and size). Select the desired thread size. The catalog number for the proper adapter is in the far left column.



Adapter for Flare Copper



Adapter for Male Iron Pipe

CATALOG NUMBER	FLARE COPPER THREAD	CORPORATION BODY OUTLET THREAD TYPE (NOMINAL THREAD SIZE)			INSIDE GASKET
		MALE IRON PIPE THREADS	SPECIAL QUICK JOINT THREAD	FEMALE IRON PIPE THREAD	
DMA2-1	1/2"				GT-106
DMA2-2	5/8"				GT-107
** DMA2-3	3/4"				GT-118
** DMA2-4	1"				GT-119
+ DMA2-5	1-1/4"				GT-147
DMA2-6	1-1/2"				GT-143
DMA2-7	2"				GT-132
DMA1-3		3/4"			GT-114
DMA1-4		1"			GT-120
+ DMA1-5		1-1/4"			GT-119
DMA1-6		1-1/2"			GT-142
DMA1-67		2" (1-1/2" FB800/900 Ballcorps)			GT-143
DMA1-7		2"			GT-144
DMA1-78		2-1/2" (2" FB800/900 Ballcorps)			GT-132
+ DMA4-5-Q			1-1/4" CTS Quick Joint		GT-128
DMA4-5F-Q			1-1/4" CTS Quick Joint		GT-262
DMA4-6-Q			1-1/2" CTS Quick Joint		GT-126
DMA4-7-Q			2" CTS Quick Joint		GT-127
DMA6-3-Q			3/4" PEP Quick Joint		GT-119
DMA6-4-Q			1" PEP Quick Joint		GT-128
DMA8-6				1-1/2" (1-1/2" FB1600/1700 Ballcorps)	650223
DMA8-7				2" (2" FB1600/1700 Ballcorps)	650227

BORING BARS: Select the boring bar that corresponds to the cutting tool(s) that meet your drilling requirements. The catalog number for the proper boring bar is in the far left column.



CATALOG NUMBER	CORRESPONDING CUTTING TOOLS
DMBB-1	DMD-1, DMSC-1
DMBB-2	DMD-2
▲** DMBB-3	DMD-3, DMSC-3,
▲** DMBB-4A	DMD-4A, DMSC-4A
DMBB-67	DMSC-6-DI, DMSC-6-PVC, DMSC-7-DI, DMSC-7-PVC, DMD-5-DI, DMSC-5-PVC
* DMBB-67 & * DMA-67	DMHS-7

- NOTES:**
- * DMA-67 (Drilling Machine Arbor) is required for 2" Hole Saw, DMHS-7
 - ** This item is included in the complete Drilling Machine Kit, **Catalog Number DMK-1-12A.**
 - ▲ This item is included in the Drilling Machine Only, **Catalog Number DMO-1-9A.**
 - + For use with 7/8" (1" nominal) Drill or Shell Cutter.

Operating Instructions

CAUTION: Always follow pipe manufacturer's recommendations to protect from injury.

1. Remove the Drilling Machine from the Tool Box (DMTB) and lay it on a flat surface. Back the Feedscrew (DMHF) out until the end is flush with the Yoke Assembly (DMY).



2. Select the diameter of Boring Bar (DMBB) which will pass through the corporation stop when it is open. Attach the Drill (DMD) to the Boring Bar (DMBB) and lightly tighten with the adjustable wrenches.



3. Insert the Boring Bar (DMBB) into the body of the machine until the shoulder hits the stop. Gently tighten the Packing Bushing (DMPB).



4. Select the Adapter (DMA) that matches the outlet threads on the corporation stop. Attach the Adapter (DMA) to the bottom of the Drilling Machine.



5. Mount the pipe saddle and corporation stop on the water main and tighten the saddle straps. Mount the Drilling Machine onto the corporation stop. **Check to be sure the corporation stop is fully open.**



6. Carefully lower the Drill (DMD) until it touches the water main. Attach the Ratchet (DMRW) to the top of the Boring Bar (DMBB). Raise the Yoke (DMY) until the Feedscrew (DMHF) is centered over the Boring Bar (DMBB). Place a few drops of oil on the point of the Feedscrew (DMHF) and mate the point with the center of the Boring Bar (DMBB). Open Chip Flushing Port (if equipped.)

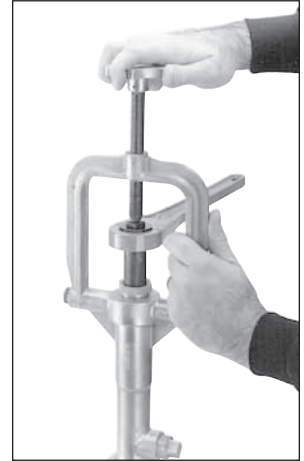

7. Rotate the Ratchet (DMRW) clockwise **only** while applying a **light** turn of the Feedscrew (DMHF). Make at least two (2) quarter turns of the Ratchet (DMRW) before applying more pressure on the Feedscrew (DMHF). Use Feedscrew (DMHF) as follower only and exert light pressure on the Boring Bar (DMBB). When drilling PVC pipe use a steady continuous cutting action and do **not** stop until the cutter is completely through the pipe. With PVC it is important to continue cutting until the Shell Cutter has penetrated the wall of the water main and the Boring Bar (DMBB) shoulder contacts the bottom stop in the Adapter (DMA).

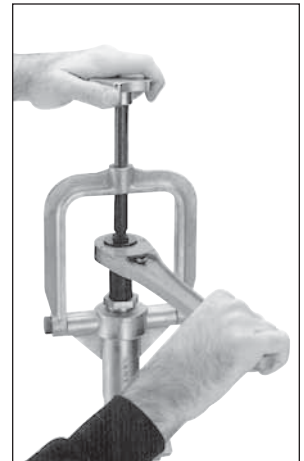

8. Slowly reverse the Feedscrew (DMHF) and allow the Boring Bar (DMBB) to back out until it hits the top stop in the machine. Close the corporation stop and release the entrapped pressure before removing the Drilling Machine from the corporation stop.



IMPORTANT - GENERAL MAINTENANCE

1. Clean the tools and lightly oil the Boring Bar (DMBB) and Cutters before returning them to the Tool Box (DMTB).
2. When using the PVC Shell Cutter (DMSC), the assembly and operation is the same as using a Drill (DMD). For 3/4" PVC taps, use the 11/16" Shell Cutter (DMSC-3). For 1" PVC taps, use the 7/8" Shell Cutter (DMSC-4A).
3. Check the Cutters regularly for sharpness. Sharp Cutters will assure an easy tap. Professional sharpening is a good investment because the cutting edge will have the proper angle, lip clearance, and chisel point to match the hardness of the pipe.
4. When the day's work is completed, always dismantle and replace the Drilling Machine in the Tool Box so nothing will be lost or damaged. **Cutters will break easily** if the machine assembly is **dropped or mishandled**. Simple preventative maintenance will make this device last for many years at a minimal cost per tap.

Assembly Instructions for 1-1/4", 1-1/2" and 2" Shell Cutters

For drilling Cast Iron, Ductile, PVC and A/C Pipe

1. Insert the Boring Bar (DMBB-67) into the Drilling Machine (Fig. 1).
2. Select the Adapter (DMA) that matches the outlet threads of the corporation stop and attach it to the bottom of the Drilling Machine (Fig. 2).
3. Follow the drilling procedure as outlined on page 6. **When a Shell Cutter is cutting into the pipe, NEVER reverse the direction of rotation or the carbide teeth will be destroyed. ALWAYS TURN CLOCKWISE.**

When making dry taps on Cast Iron, Ductile or A/C pipe, the 1/4" "Split Tipped" Pilot Drill should be used for coupon retention.

Fig. 1

Insert the Boring Bar into the Drilling Machine.



Fig. 2

Select the proper Drilling Machine Adapter and attach it to the Drilling Machine.

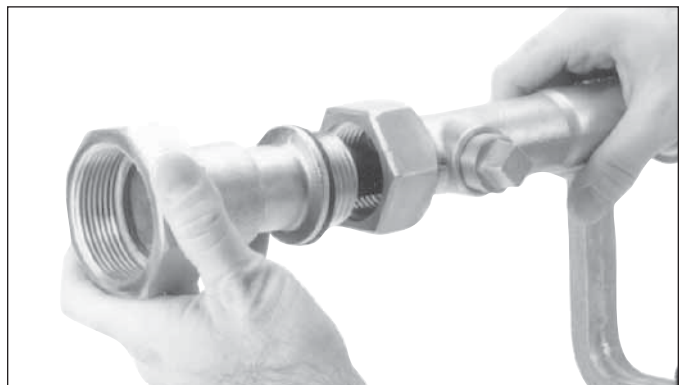
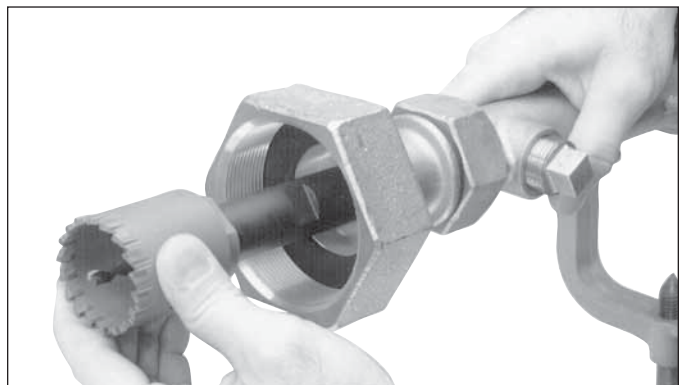

Fig. 3

Attach the Shell Cutter to the end of the Boring Bar.



The following is a quotation from the Uni-Bell "Tapping Guide for PVC Pressure Pipe" Uni-Pub-8-88, page 10.

PVC is easy to machine. So it is a temptation to overfeed the cutter because it is comparatively easy to turn the ratchet handle. The principle is to allow the cutter to work as a **cutter**. Rotate the ratchet handle one complete turn for every 1/8 turn of the feed yoke (approx. 1-inch (25mm) movement of feed nut to each 1/4 turn of the ratchet handle).

The feed rate should be less in cold weather. Judge the correct feed rate by "finger pull" – the effort should be about the same used to open a desk drawer. This rule of thumb applies in any temperature.

The Ford Drilling Machine Adapters

Option Selection Charts: Cutting Tools, Adapters and Boring Bars

Table of Recommended Drill Sizes

for installation of Corporation Stops in Service Clamps or Saddles with a Drilling Machine

CORPORATION STOP SIZE	1/2"	5/8"	5/8"x3/4"	3/4"	3/4"x1"	1"	1-1/4"	1-1/2"	2"
Maximum Drill Size for Stop with AWWA thread inlet	7/16"	9/16"	9/16"	11/16"	11/16"	15/16"	1-3/16"	1-7/16"	1-7/8"
Maximum Drill Size for Stop with iron pipe thread inlet	7/16"	-	-	11/16"	11/16"	7/8"	1-3/16"	1-7/16"	1-7/8"

Recommended Drill Machine Adapters

SIZE	FORD CORPORATION NUMBER	OUTLET THREADS	MUELLER		ROMAC	RIDGID	REED	FORD
			E-4 & E-5	D-4 & D-5	TAPMATE TOO	MLT3401	DM1100	MODEL 77
1/2"	F1000	1/2" Fl. Copper	63796	-	-	-	-	DMA2-1
5/8" X 3/4"	F1000	3/4" Fl. Copper	52019	37902	351-05-506	92097	08423	DMA2-3
3/4"	F (or FB) 1000, 1100							
3/4"	F (or FB) 1001, 1101, 1002, 1102	1" Fl. Copper	36750	37903	351-05-508	92102	08424	DMA2-4
3/4" x 1"	F (or FB) 1000, 1100							
1"	F (or FB) 1000, 1100							
3/4" x 1"	F1001, 1101, 1002, 1102	1-1/4" Fl. Copper	45385	37904	351-05-510	92107	-	DMA2-5
1"	F (or FB) 1001, 1101, 1002, 1102							
1" x 1-1/4"	F (or FB) 1000, 1100							
1-1/4"	FB1000, 1100	1-1/2" Fl. Copper	501947	37905	351-05-512	92112	08425	DMA2-6
1-1/4" x 1-1/2"	FB1000, 1100							
1-1/2"	FB1000, 1100, 1002, 1102							
1-1/2" x 2"	FB1001, 1101	2" Fl. Copper	508201	37906	351-05-516	92117	08426	DMA2-7
2"	FB1000, 1100							
	FB1001, 1101, 1002, 1102							
SPECIAL ADAPTERS								
3/4"	F (or FB) 1001-3-Q, 1101-3-Q	Special Thread	508919	508917	-	-	08423	DMA6-3-Q
1"	F (or FB) 1001-4-Q, 1101-4-Q		508920	508918	-	-	08424	DMA6-4-Q
1-1/2"	FB1000-6-Q, 1100-6-Q		501949	507644	351-05-712	92157	08431	DMA4-6-Q
1-1/4"	FB1000-5-Q, 1100-5-Q						-	DMA4-5F-Q
2"	FB1000-7-Q, 1100-7-Q		508199	507645	351-05-716	92162	08432	DMA4-7-Q

Recommended Tapping Machine Adapters

SIZE	FORD CORPORATION NUMBER	OUTLET THREADS	MUELLER			REED	RIDGID	
			B-100 & B-101	B	A-2 & A-3	TM100	MLT3401	
5/8" X 3/4"	F1000	3/4" Fl. Copper	680600	680600	680600	98423	92182	
3/4"	F (or FB) 1000, 1100							
3/4"	F (or FB) 1001, 1101, 1002, 1102	1" Fl. Copper	680601	680601	680601	98424	92187	
3/4" x 1"	F (or FB) 1000, 1100							
1"	F (or FB) 1000, 1100							
3/4" x 1"	F1001, 1101, 1002, 1102	1-1/4" Fl. Copper	680602	-	680602	-	-	
1"	F (or FB) 1001, 1101, 1002, 1102							
1" x 1-1/4"	F (or FB) 1000, 1100							
1-1/4"	FB1000, 1100	1-1/2" Fl. Copper	-	-	88640	-	-	
1-1/4" x 1-1/2"	FB1000, 1100							
1-1/2"	FB1000, 1100, 1002, 1102							
1-1/2" x 2"	FB1001, 1101	2" Fl. Copper	-	-	88641	-	-	
2"	FB1000, 1100							
	FB1001, 1101, 1002, 1102							
Special Adapters								
3/4"	F (or FB) 1001-3-Q, 1101-3-Q	Special Thread	680688	-	-	98423	-	
1"	F (or FB) 1001-4-Q, 1101-4-Q		680689	-	680689	98424	-	
1-1/2"	FB1000-6-Q, 1100-6-Q		-	-	680421	-	-	
2"	FB1000-7-Q, 1100-7-Q		-	-	680422	-	-	

WARNING: Some tapping machine adapters, furnished by the tapping machine manufacturers, are not threaded all the way to the bottom of the adapter. This can cause problems when installing Ford Pack Joint and Grip Joint style Corporation Stops. If your adapter is not threaded to the bottom, a free washer-type screw plug adapter is available from Ford.

Section AB

Ford Drilling Machine

Warranty

All merchandise is warranted to be free from defects in material and factory workmanship. We will provide free of charge new products in equal quantities for any that prove defective within one year from date of shipment from our factory. Manufacturer shall not be liable for any loss, damage, or injury, direct or consequential, arising out of the use of or the inability to use the product. Before using, user shall determine the suitability of product for his intended use and user assumes all risk and liability whatever in connection therewith. No claims for labor or consequential damage will be allowed. The foregoing may not be changed except by agreement signed by an officer of the manufacturer.

Please Note:

Consult the Ford Meter Box Company, Inc. website (www.fordmeterbox.com) for the most recent catalog information. The Ford Meter Box Company considers the information in this catalog to be correct at the time of publication. Items and option availability, including specifications, are subject to change without notice. Please verify that your product information is current.



The Ford Meter Box Co., Inc. 775 Manchester Avenue, P.O. Box 443, Wabash, Indiana, USA 46992-0443
Telephone: 260/563-3171 FAX: 800-826-3487 Overseas FAX: 260/563-0167 <http://www.fordmeterbox.com>