

THE FORD FACC CORP CAP - INSTALLATION INSTRUCTIONS

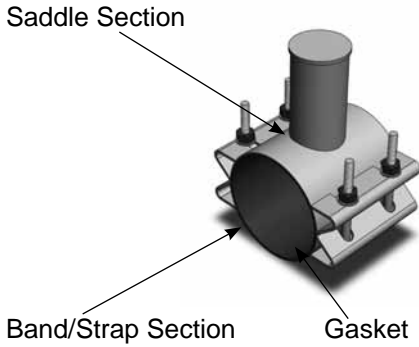

Refer to the FMB website (<http://www.fordmeterbox.com>) for additional and most recent instructions and product information.

1. Your FACC Corp Cap is warranted to be free of defects at the time of shipment. Please visually inspect before installing to ensure that no damage has occurred during shipment or storage.

Clean any dirt, corrosion, or foreign material from pipe surface. Measure the pipe diameter and check it against the FACC range indicated on the sleeve. Lubricate the pipe with a thin coating of a soap-based (non-petroleum) lubricant.

2. Place the top saddle section of the Corp Cap on the pipe over the existing corporation stop and lightly lubricate the outside surfaces of the exposed gasket. Mate the band/strap section with the saddle section on the pipe making sure the tapered ends of the gasket are not folded or rolled against the pipe. Make sure no foreign material is trapped between the pipe and the gasket. Loosely install the lug bolts and hand tighten the nuts to hold the unit in place.

3. Begin tightening the bolts using the pattern shown in the diagram below. Make sure the gap between the sleeve sections is equal from side to side and equal from end to end.

To achieve proper torque and gap, you must tighten all the bolts several times with incremental torque settings, up to the **recommended torque of 75 ft-lbs.**

Check final torque several times prior to backfilling. The gasket will continue to compress until it is fully seated.

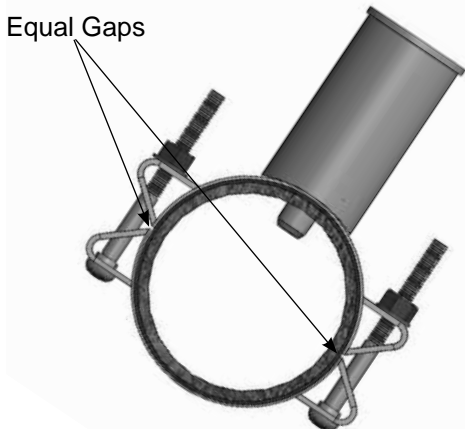
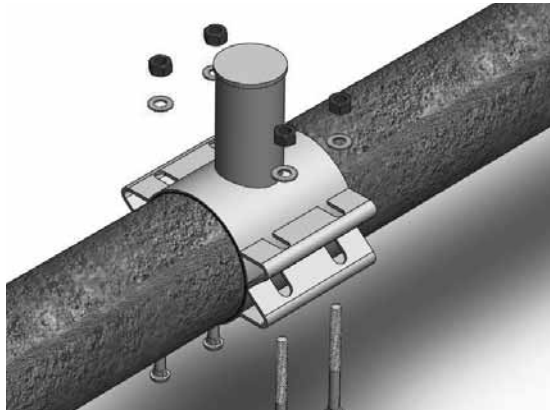
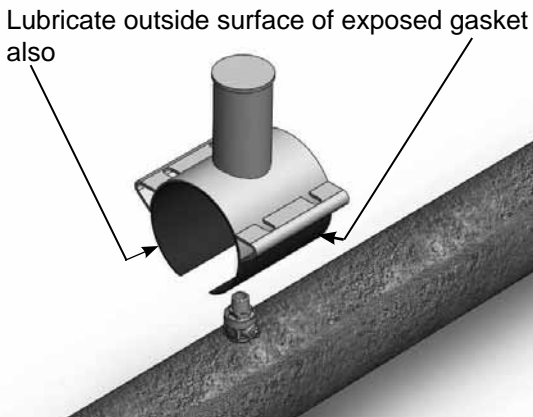

Bolt tightening sequence

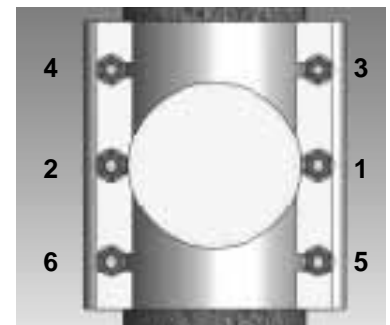
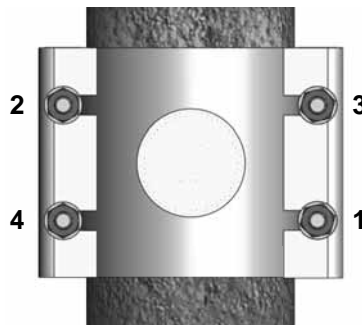

The Ford Meter Box Co., Inc.

775 Manchester Avenue, P.O. Box 443, Wabash, Indiana, USA 46992-0443
 Telephone: 260-563-3171 FAX: 800-826-3487 Overseas FAX: 260-563-0167
<http://www.fordmeterbox.com>