

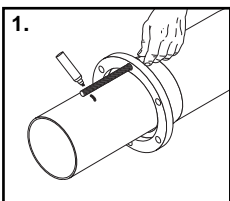

UFR1300-CAS MJ Gland Repair Kit Installation Instructions For Ductile Iron or C900 PVC

Refer to the Ford website (<http://www.fordmeterbox.com>) for additional and most recent installation instructions and product information.



1. Insert pipe into mechanical joint bell if necessary. Insert one of the extra long T-Bolts provided through one of the flange holes. Mark a line on the pipe approximately 1 inch shorter than the bolt length.

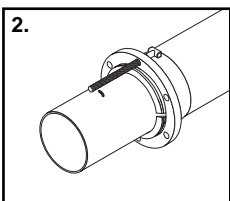

2. Assemble the split gasket. Heavily lubricate the gasket and work it into the MJ cavity by hand, prior to tightening the MJ bolts. Make sure the gasket split is located 90 degrees from the MJ gland long assembly bolt. (See Figure 4B)

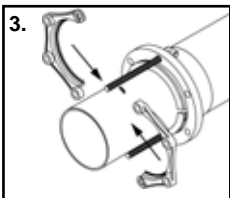

3. Assemble the split MJ gland using the extra long T-bolts provided with the Series 1300. These T-bolts are to go through the split hole in the MJ gland and the restraining ears of the 1300.

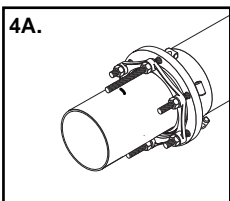

4A. Tighten the MJ bolts to approximately 20-30 Ft-lb. Begin tightening the bolts 180 degrees from the split in the gasket as shown in Figure 4B. Tighten the remaining nuts by working towards the split in the gasket.

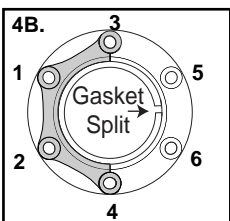

4B. Example for T-Bolt tightening sequence.

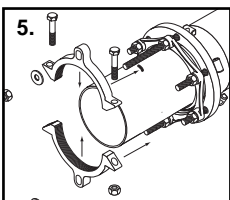

5. Assemble the Series 1300 clamping ring onto the pipe even with the line. (Make sure restrainer ears line up with the split bolt hole and extra long T-Bolts in the MJ gland as shown). Tighten clamping bolts to recommended torque.

NOMINAL PIPE SIZE	RECOMMENDED CLAMPING BOLT TORQUE
4" and 6"	100 ft. lbs.
8"	150 ft. lbs.
10" and 12"	200 ft. lbs.

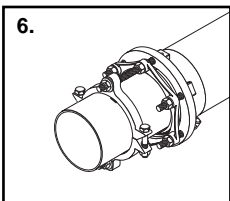

6. Finish tightening nuts against MJ gland to AWWA recommendations (75-90 ft. lbs.) using the same nut tightening sequence as instruction four. Snug retaining nuts behind restrainer ears of the 1300. Do not over-tighten retaining nuts.



The Ford Meter Box Company, Inc.
P.O. Box 443, Wabash, IN 46992-0443
260-563-3171 / FAX: 800-826-3487
Internet: <http://www.fordmeterbox.com>