

**RECOMMENDED
CLAMPING BOLT
TORQUE RANGE**

**14"-24" Sizes
200 to 225 ft. lb.**

1309 Installation Instructions / 14" - 24" PVCO*

Refer to the Ford® website (www.fordmeterbox.com) for additional and most recent installation instructions and product information.

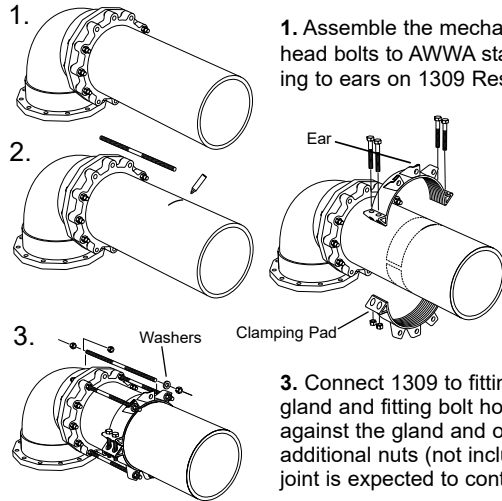

1. Assemble the mechanical joint, installing gasket, gland and Tee-head bolts to AWWA standards. Leave out Tee-head bolts corresponding to ears on 1309 Restrainer.

2. Use one of the rods (provided) as a guide to mark the position of the 1309 restrainer. Leave sufficient threads on the rod ends to fully engage nuts. Tighten clamping bolts on each side evenly, to recommended torque, ensuring the gaps between pads on both sides remain even. A torque wrench is required to ensure proper torque. The clamping pads will not touch.

3. Connect 1309 to fitting by inserting all rods through restrainer ear, gland and fitting bolt hole. Install one nut behind fitting bell, one against the gland and one behind restrainer ear (against washer). Use additional nuts (not included) on inside of retainer ears and gland if pipe joint is expected to contract.

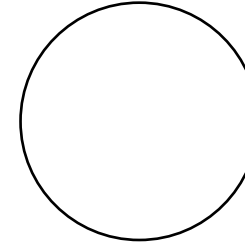

* Contact Ford Meter Box for alternate pipeline materials, water pressure ratings and clamping bolt torque requirements.



The Ford Meter Box Company, Inc., 775 Manchester Avenue, P.O. Box 443, Wabash, Indiana, USA 46992-0443
Telephone: 260-563-3171 FAX: 800-826-3487 Overseas FAX: 260-563-0167 www.fordmeterbox.com



06/18

FORM # 99013-99

1399 Installation Instructions / 14" - 24" PVCO*

Refer to the Ford® website (www.fordmeterbox.com) for additional and most recent installation instructions and product information.

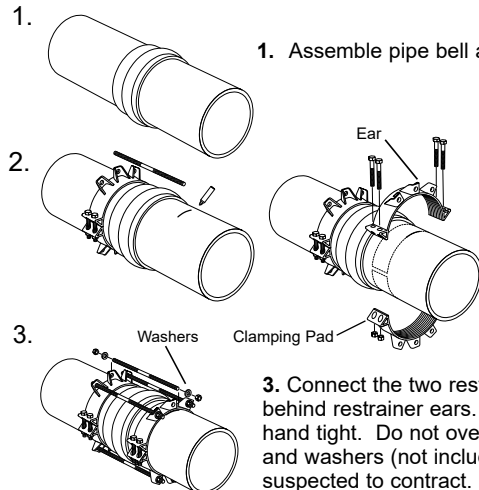

1. Assemble pipe bell according to pipe manufacturer's instructions.

2. Assemble one restrainer on spigot end of pipe, and one directly behind pipe bell. Use one of the rods (provided) as a guide to mark the position of the serrated restrainers. Leave sufficient threads on the rod ends to fully engage nuts. Tighten clamping bolts on each side evenly, to recommended torque, ensuring the gaps between pads on both sides remain even. A torque wrench is required to ensure proper torque. The clamping pads will not touch.

3. Connect the two restrainers using all rods provided. Place a washer behind restrainer ears. Tighten all retaining nuts 1/2 revolution beyond hand tight. Do not over-tighten retaining nuts. Use additional nuts and washers (not included) on inside of retainer ears if pipe joint is suspected to contract.

**RECOMMENDED
CLAMPING BOLT
TORQUE RANGE**

**14"-24" Sizes
200 to 225 ft. lb.**

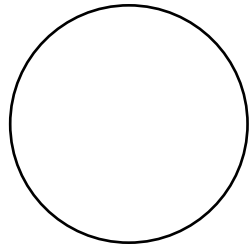

* Contact Ford Meter Box for alternate pipeline materials, water pressure ratings and clamping bolt torque requirements.



The Ford Meter Box Company, Inc., 775 Manchester Avenue, P.O. Box 443, Wabash, Indiana, USA 46992-0443
Telephone: 260-563-3171 FAX: 800-826-3487 Overseas FAX: 260-563-0167 www.fordmeterbox.com



06/18

FORM # 99013-99