

Meter Flange



LXI Products meet
ANSI/NSF Standard 61
see page 3



Female Iron Pipe



Male Iron Pipe

CATALOG NUMBER	DESCRIPTION	APPROX. WT. LBS.	STD. PKG. QTY.
CF31-66	1-1/2" Meter Flange x 1-1/2" Female Iron Pipe Thread	2.2	8
CF31-67	1-1/2" Meter Flange x 2" Female Iron Pipe Thread	1.9	8
+ CF31-77	2" Meter Flange x 2" Female Iron Pipe Thread	2.8	5
CF31-78	2" Meter Flange x 2-1/2" Female Iron Pipe Thread	3.2	5
* CF38-66-2	1-1/2" Meter Flange x 1-1/2" Male Iron Pipe Thread	2.4	5
+ CF38-77-1.937	2" Meter Flange x 2" Male Iron Pipe Thread	3.2	3
+* CF38-77-2.125	2" Meter Flange x 2" Male Iron Pipe Thread	3.2	3

* Standard Length

+ Slotted bolt holes are available on 2" Meter Flanges to allow 1-1/2" meter installations.

Note: Drop-in rubber gaskets are included with all 1-1/2" and 2" Meter Flanges and Flange Ells. Flange Couplings are not supplied with bolts. Steel bolts and nuts (5/8" x 2-1/2" Zinc Plated) for attaching 1-1/2" & 2" Flanges and Flange Ells are sold separately and are supplied in pairs. (Cat. No.: PSB)

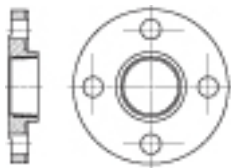

RF-2I Flange

Four Bolt Round Flange

CATALOG NUMBER	DESCRIPTION	APPROX. WT. LBS.	STD. PKG. QTY.
RF-2I	2" 4-Bolt Meter Flange x 2" Female Iron Pipe Thread	4.4	5

Meter Adapters



A47 Adapter



Adapt from 1" to 2" meter with A14 Adapter



Adapt from 1" to 5/8" meter with A14 Adapter

CATALOG NUMBER	DESCRIPTION - USAGE	APPROX. WT. LBS.	STD. PKG. QTY.
ADAPTER RINGS TO BUSH METER SPUDS (NO CHANGE IN METER LENGTH)			
A12S	Pair short adapter rings to bush 5/8" meter spuds to 5/8"x3/4" meter spud size	.1	100 Pair
A12M	Pair medium adapter rings to bush 5/8" meter spuds to 5/8"x3/4" meter spud size	.1	100 Pair
A12L	Pair long adapter rings to bush 5/8" meter spuds to 5/8"x3/4" meter spud size	.2	75 Pair
A34S	Pair short adapter rings to bush 3/4" meter spuds to 1" meter spud size	.3	50 Pair
A45	Pair adapter rings to bush 1" meter spuds to 1-1/4" meter spud size	.2	35 Pair
ADAPTERS TO CHANGE METER SPUD SIZE AND/OR LENGTH			
A13	Pair adapters to change 5/8" meter to 3/4" meter spud size and length	.5	35 Pair
A14	Pair adapters to change 5/8" meter to 1" meter spud size and length	.8	15 Pair
A23	One adapter to change 5/8"x3/4" meter to 3/4" meter length	.4	30 Each
A24	Pair adapters to change 5/8"x3/4" meter to 1" spud size and length	1.1	12 Pair
A34	Pair adapters to change 3/4" meter to 1" meter spud size and length	.8	24 Pair
A44	One adapter to change 3/4"x1" meter to 1" meter length	.8	16 Each
A46	Pair adapters to change 1" meter to 1-1/2" flanged meter size and length	4.0	3 Pair
A47	Pair adapters to change 1" meter to 2" flanged meter size and length	7.1	1 Pair
A67	Pair adapters to change 1-1/2" flanged meter to 2" flanged meter size and length (eight special length bolts included)	8.7	2 Pair
TA46	Pair adapters to change 1" meter to 1-1/2" tapped meter size and length	1.5	8 Pair
TA47	Pair adapters to change 1" meter to 2" tapped meter size and length	3.0	4 Pair

Note: Adapter numbers A23 and A44 extend the meter length only and therefore only one per meter is required. All other adapters are sold in pairs; the part number and weight reflects a pair.

Options Available

No-Lead alloy is available, add "-NL" to the end of the catalog number. With the No-Lead option, brass components in contact with potable water shall be of No-Lead Alloy, UNS/CDA No. C89833. Brass components that do not come in contact with potable water shall be UNS/CDA No. C83600.